

AVAILABLE FOR LEASE

3865 TAYLOR ROAD | LOOMIS

PROPERTY HIGHLIGHTS

- Rare Small Industrial Spaces
- 900 to 1,500 SF Units
- 5,100 SF Total Available (Can be combined)
- Roll Up Door for Every Unit
- Remodel Completed in November 2024
- New Roof, Insulation, Electrical, Sheetrock
- Industrial GROSS Leases
- Local Property Management

COLE STROMBOM

650-302-3805

cole@strombom.com

LIC. #01953946

OFFICE CONTACT

916-299-6698

www.strombom.com

LIC. #02155363



STROMBOM
PROPERTIES, INC.

FLOOR PLAN



[VIDEO TOUR](#)



[VIDEO TOUR](#)

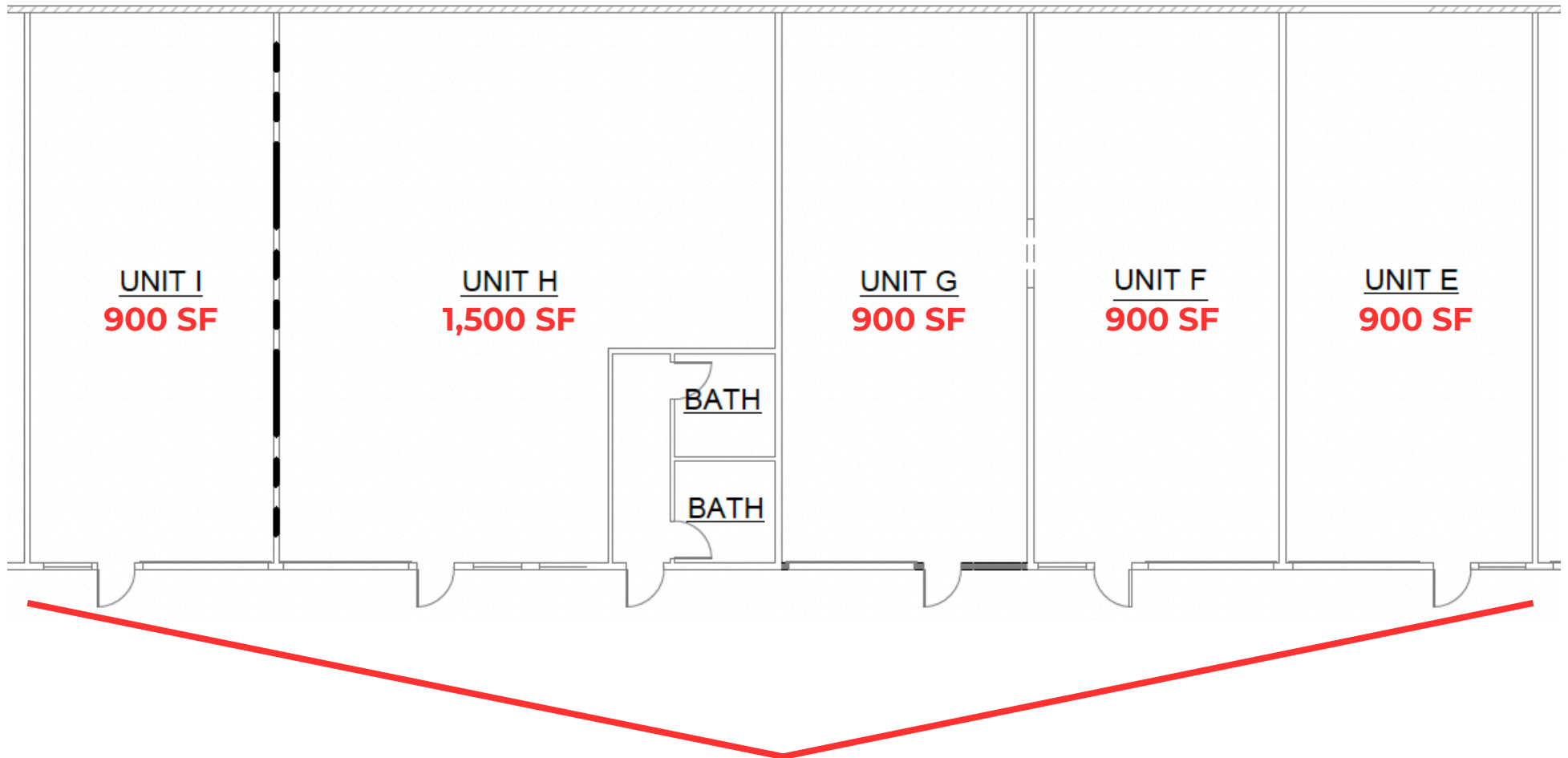

**SPACES CAN BE COMBINED RANGING FROM 1,800 SF UP TO 5,100 SF

SITE PLAN

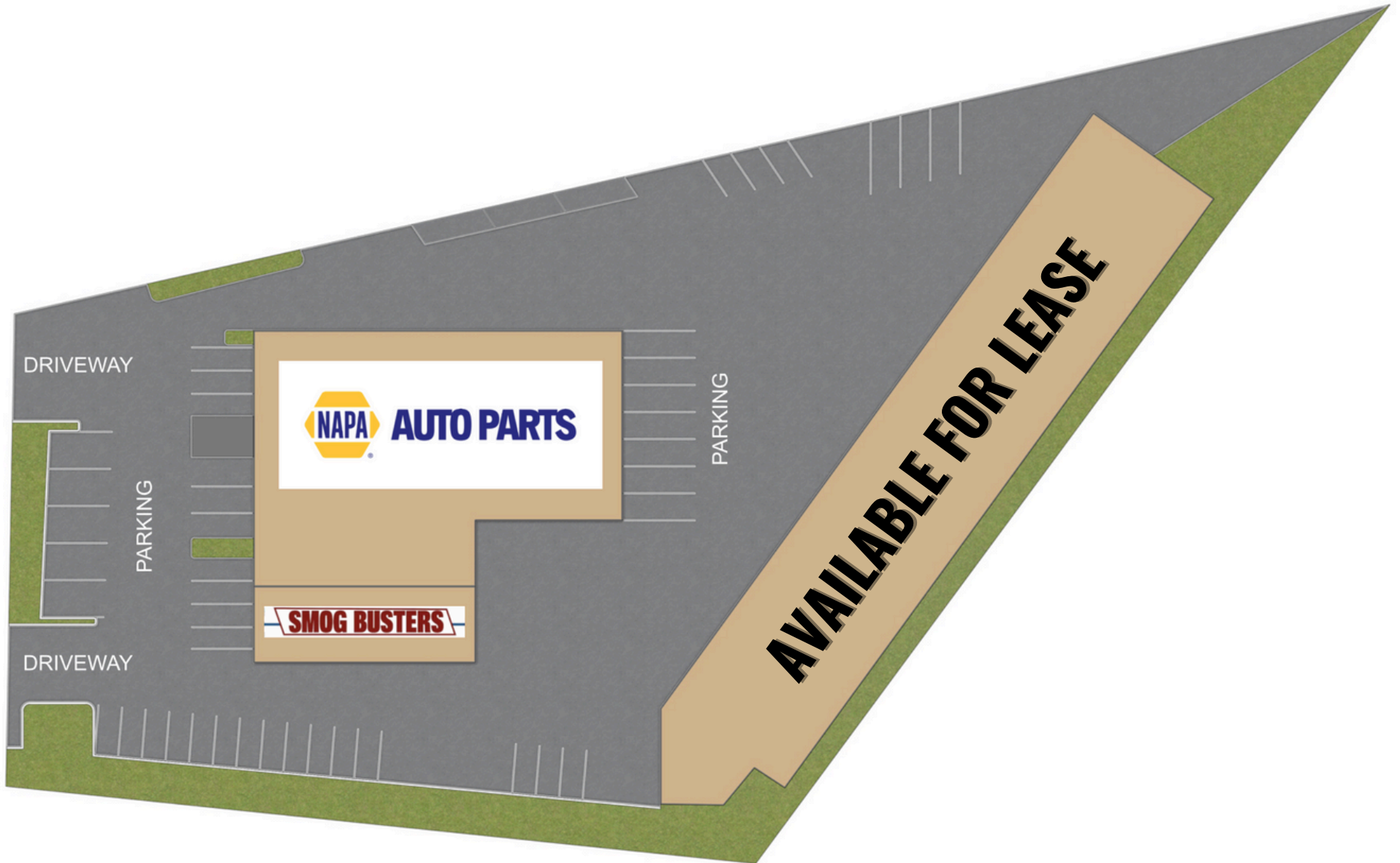

PICTURES



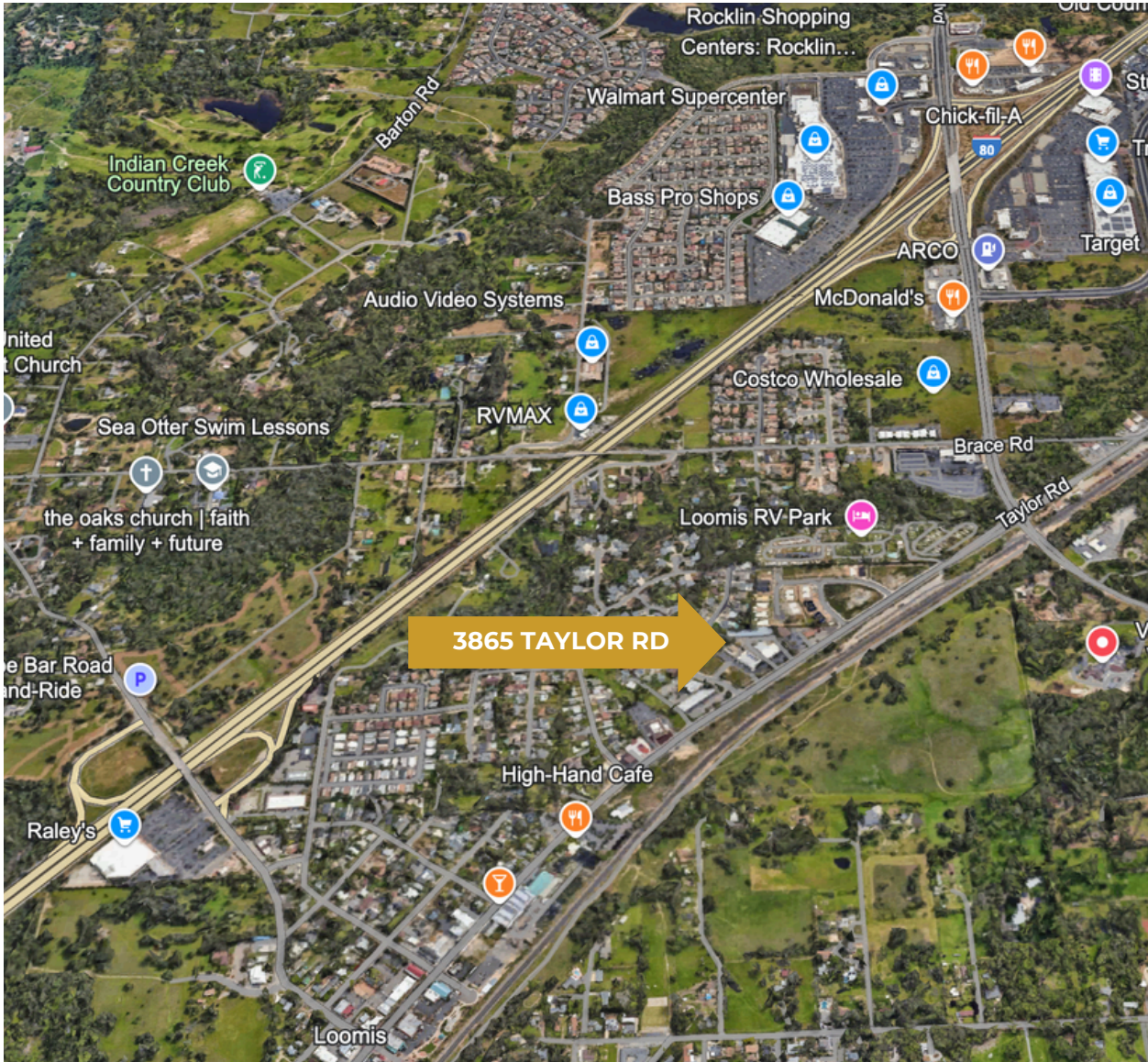

NEARBY BUSINESSES

- Costco
- Target
- Trader Joe's
- Starbucks
- Chic-Fil-A
- High Hand Cafe, Nursery & Shops
- High Hand Brewery
- Red's Bistro
- LBB Gastro Pub
- Smithville & Co
- ACE Hardware
- US Post Office
- Wells Fargo
- US Bank
- Blue Goose Event Center
- Napa Auto Parts
- White Cap Building Materials
- Valley Rock Landscape Material
- Homewood Lumber & Supply

COLE STROMBOM

650-302-3805

cole@strombom.com

LIC. #01953946

OFFICE CONTACT

916-299-6698

www.strombom.com

LIC. #02155363

